

# BRIDA BLIND ASME B16.5 - CLASE 150

## BLIND FLANGE ASME B16.5 - CLASS 150

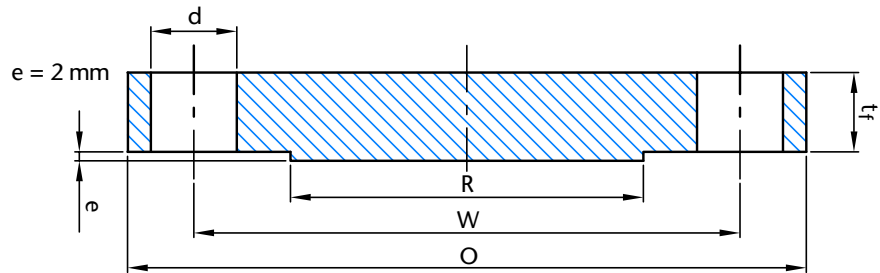

CLASE 150  
CLASS 150



### INFORMACIÓN TÉCNICA - TECHNICAL INFORMATION

| Designación - Designation |                                  | Brida - Flange |  |  |                 |                                     |   | Tornillos - Bolting |                  | Peso aprox.<br>Weight approx.<br>(kg) |                      |
|---------------------------|----------------------------------|----------------|--|--|-----------------|-------------------------------------|---|---------------------|------------------|---------------------------------------|----------------------|
| COD.                      | Diámetro Nominal<br>Nominal size |                | Diámetro exterior<br>External diameter | Distancia entre taladros<br>Distance between holes | Asiento<br>Seat | Mínimo espesor<br>Minimum thickness | Diámetro para tornillo<br>Diameter of bolt hole |                     | Número<br>Number |                                       | Diámetro<br>Diameter |
|                           | DN                               | NPS            | O<br>(mm)                              | W<br>(mm)  | R<br>(mm)       | t <sub>f</sub><br>(mm)              | d<br>(inches)                                   | d<br>(mm)           | nr<br>(n)        | Ø<br>(inches)                         |                      |
| FB150015                  | 15                               | 1/2"           | 90                                     | 60,3   | 34,9            | 9,6                                 | 5/8"  | 15,88               | 4                | 1/2"                                  | 0,40                 |
| FB150020                  | 20                               | 3/4"           | 100                                    | 69,9   | 42,9            | 11,2                                | 5/8"  | 15,88               | 4                | 1/2"                                  | 0,70                 |
| FB150025                  | 25                               | 1"             | 110                                    | 79,4   | 50,8            | 12,7                                | 5/8"  | 15,88               | 4                | 1/2"                                  | 0,90                 |
| FB150032                  | 32                               | 1 1/4"         | 115                                    | 88,9   | 63,5            | 14,3                                | 5/8"  | 15,88               | 4                | 1/2"                                  | 1,30                 |
| FB150040                  | 40                               | 1 1/2"         | 125                                    | 98,4   | 73,0            | 15,9                                | 5/8"  | 15,88               | 4                | 1/2"                                  | 1,60                 |
| FB150050                  | 50                               | 2"             | 150                                    | 120,7  | 92,1            | 17,5                                | 3/4"  | 19,05               | 4                | 5/8"                                  | 2,60                 |
| FB150065                  | 65                               | 2 1/2"         | 180                                    | 139,7  | 104,8           | 20,7                                | 3/4"  | 19,05               | 4                | 5/8"                                  | 4,10                 |
| FB150080                  | 80                               | 3"             | 190                                    | 152,4  | 127,0           | 22,3                                | 3/4"  | 19,05               | 4                | 5/8"                                  | 5,00                 |
| FB150100                  | 100                              | 4"             | 230                                    | 190,5  | 157,2           | 22,3                                | 3/4"  | 19,05               | 8                | 5/8"                                  | 7,10                 |
| FB150125                  | 125                              | 5"             | 255                                    | 215,9  | 185,7           | 22,3                                | 7/8"  | 22,23               | 8                | 3/4"                                  | 9,00                 |
| FB150150                  | 150                              | 6"             | 280                                    | 241,3  | 215,9           | 23,9                                | 7/8"  | 22,23               | 8                | 3/4"                                  | 11,80                |
| FB150200                  | 200                              | 8"             | 345                                    | 298,5  | 269,9           | 27,0                                | 7/8"  | 22,23               | 8                | 3/4"                                  | 21,00                |
| FB150250                  | 250                              | 10"            | 405                                    | 362,0  | 323,8           | 28,6                                | 1"  | 25,40               | 12               | 7/8"                                  | 30,00                |
| FB150300                  | 300                              | 12"            | 485                                    | 431,8  | 381,0           | 30,2                                | 1"  | 25,40               | 12               | 7/8"                                  | 45,00                |
| FB150350                  | 350                              | 14"            | 535                                    | 476,3  | 412,8           | 33,4                                | 1 1/8"  | 28,58               | 12               | 1"                                    | 59,00                |
| FB150400                  | 400                              | 16"            | 595                                    | 539,8  | 469,9           | 35,0                                | 1 1/8"  | 28,58               | 16               | 1"                                    | 79,00                |
| FB150450                  | 450                              | 18"            | 635                                    | 577,9  | 533,4           | 38,1                                | 1 1/4"  | 31,75               | 16               | 1 1/8"                                | 97,00                |
| FB150500                  | 500                              | 20"            | 700                                    | 635,0  | 584,2           | 41,3                                | 1 1/4"  | 31,75               | 20               | 1 1/8"                                | 124,00               |
| FB150600                  | 600                              | 24"            | 815                                    | 749,3  | 692,2           | 46,1                                | 1 3/8"  | 34,92               | 20               | 1 1/4"                                | 189,00               |

### CARACTERÍSTICAS BÁSICAS

- Material según ASTM A105.
- Conformes la norma ASME B16.5 - Clase 150.
- Todas las instalaciones deben cumplir los valores P-T según los requisitos legales especificados.
- Marcado: CLASE; ATUSA; NORMA; MATERIAL; DN; NPS; N° DE COLADA.

### APLICACIONES GENERALES

- Sistemas de aguas generales.
- Plantas de abastecimiento, bombeo y acometidas de aguas.
- Aplicaciones industriales.
- Instalaciones Contra Incendios.
- Aceites y gasóleo.

### BASIC FEATURES

- Material according to ASTM A105.
- According to ASME B16.5 - Class 150.
- All installations has to meet the P-T values specified in the legal requirements.
- Marking: CLASS; ATUSA; STANDARD; MATERIAL; DN; NPS; HEAT Number.

### GENERAL APPLICATIONS

- Water systems.
- Water supply, pumping and connection plants.
- Industrial applications.
- Fire Fighting Installations.
- Oils and diesel.

Rev.2-11.21  
1/2



Polígono Industrial ATUSA - Agurain S/N - 01200 Salvatierra (Alava) España  
Tel.: (+34) 945 18 00 00 Fax : (+34) 945 30 01 53 e-mail: [ventas@atusagroup.com](mailto:ventas@atusagroup.com)  
[www.atusagroup.com](http://www.atusagroup.com)

## BRIDA BLIND ASME B16.5 - CLASE 150

### BLIND FLANGE ASME B16.5 - CLASS 150



#### Observaciones:

Dada la complejidad, variedad y gran cantidad de especificaciones particulares de cada instalación, en conjunción con la existencia de diversos factores que pueden afectar a las condiciones de trabajo y naturaleza del producto, es responsabilidad del usuario final realizar los ensayos necesarios para garantizar el correcto funcionamiento del producto en cada aplicación concreta.

La instalación del producto deberá realizarse y mantenerse siguiendo códigos de buena práctica y/o estándares existentes.

#### Remarks:

*Due to the complexity, variety and large number of particular specifications for each installation, along with the existence of diverse factors which can affect the working conditions and nature of the product, it is the responsibility of the end-user to carry out the necessary tests to ensure the proper functioning of the product in any specific application.*

*Product installation must be carried out and maintained following the good practice codes and/or updated technical standards.*

Nota : Debido al constante desarrollo de nuestros productos, los datos suministrados pueden ser alterados sin previo aviso.

Note : Due to the continuous development of our products, specifications may be changed without notification at any time.

Rev.2-11.21

2/2



Polígono Industrial ATUSA - Agurain S/N - 01200 Salvatierra (Alava) España  
Tel.: (+34) 945 18 00 00 Fax : (+34) 945 30 01 53 e-mail: [ventas@atusagroup.com](mailto:ventas@atusagroup.com)  
[www.atusagroup.com](http://www.atusagroup.com)